

SAMMY J. DOOLEY
VOLUME 1390, PAGE 108
D.R.S.C.T.

THE BRAZOS RIVER CONSERVATION
AND RECLAMATION DISTRICT
TRACT 156-3-22
VOLUME 180, PAGE 561
CALLED 9.25 ACRES
D.R.P.P.C.T.

POSSUM KINGDOM CONTROL
MONUMENT NO. 17
N68°02'03"W, 4,870.72'

POINT OF
BEGINNING
N 7,006,196.36
E 1,939,344.44

SAMMY J. DOOLEY
VOLUME 1390, PAGE 108
D.R.S.C.T.

J. H. KARR SURVEY
ABSTRACT 1020

LEONARD KILBURN, JR.
VOLUME 521, PAGE 135
D.R.S.C.T.

N 42°40'23" E
91.89'

JAMES A. SCHERIGER, ET UX
VOLUME 367, PAGE 401
D.R.S.C.T.

B.R.A. BOUNDARY LINE
PER AGREEMENT
VOLUME 373, PAGE 581
D.R.S.C.T.

FOUND 1/2-INCH
IRON ROD
W/LAWSON CAP

FOUND 1/2-INCH
IRON ROD
W/LAWSON CAP

B.R.A. BOUNDARY LINE
PER AGREEMENT
VOLUME 373, PAGE 581
D.R.S.C.T.

FOUND 1/2-INCH
IRON ROD
W/LAWSON CAP

N 26°53'13" E
687.04'

2.8612 ACRES
124,634 SQ. FT.

LEASE BLOCK R093
AREA: 6-E

F.E.R.C. BUFFER AREA
1.0894 ACRES
47,453 SQ. FT.

POSSUM KINGDOM LAKE

THE BRAZOS RIVER CONSERVATION
AND RECLAMATION DISTRICT
TRACT 153-3-22
CALLED 152.10 ACRES
VOLUME 180, PAGE 264
D.R.S.C.T.

STANDARD LAND SURVEY
OF
3.9506 ACRES
SITUATED IN TRACT 153-3-22
AREA 6-E, LOTS W-1-A, W-1-B, W-1-C
AND 2 - 4
POSSUM KINGDOM LAKE
J. H. KARR SURVEY, ABSTRACT 1020
STEPHENS COUNTY, TEXAS

AECOM

AECOM USA GROUP, INC.
1200 SUMMIT AVENUE, SUITE 600
FORT WORTH, TEXAS 76102
WWW.AECOM.COM
817.698.6770

SHEET 2 OF 4

Date: 12/18/09

Project No. 60052528.103

60052528
R093By.dwg

B.R.A. BOUNDARY LINE
PER AGREEMENT
VOLUME 373, PAGE 581
D.R.S.C.T.

LEONARD KILBURN, JR.
VOLUME 521, PAGE 135
D.R.S.C.T.

JAMES A. SCHERIGER ET UX
VOLUME 367, PAGE 401
D.R.S.C.T.

J. H. KARR SURVEY
ABSTRACT 1020

POSSUM KINGDOM LAKE

THE BRAZOS RIVER CONSERVATION
AND RECLAMATION DISTRICT
TRACT 153-3-22
CALLED 152.10 ACRES
VOLUME 180, PAGE 264
D.R.S.C.T.

INTERIOR BLOCK
IMPROVEMENTS
NOT SHOWN

LOT 4

2.8612 ACRES
124,634 SQ. FT.

LEASE BLOCK R093
AREA: 6-E

POSSUM KINGDOM LAKE

THE BRAZOS RIVER CONSERVATION
AND RECLAMATION DISTRICT
TRACT 153-3-22
CALLED 152.10 ACRES
VOLUME 180, PAGE 264
D.R.S.C.T.

F.E.R.C. BUFFER AREA
1.0894 ACRES
47,453 SQ. FT.

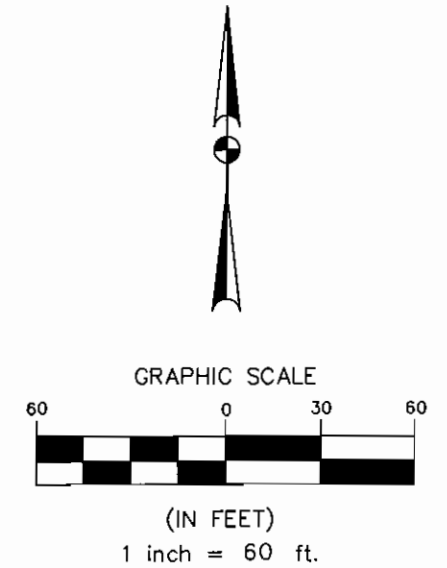

STANDARD LAND SURVEY
OF
3.9506 ACRES
SITUATED IN TRACT 153-3-22
AREA 6-E, LOTS W-1-A, W-1-B, W-1-C
AND 2 - 4
POSSUM KINGDOM LAKE
J. H. KARR SURVEY, ABSTRACT 1020
STEPHENS COUNTY, TEXAS

AECOM

AECOM USA GROUP, INC.
1200 SUMMIT AVENUE, SUITE 600
FORT WORTH, TEXAS 76102
WWW.AECOM.COM
817.698.6770

LEASE BLOCK R093
AREA: 6-E

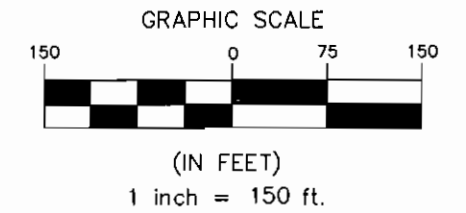
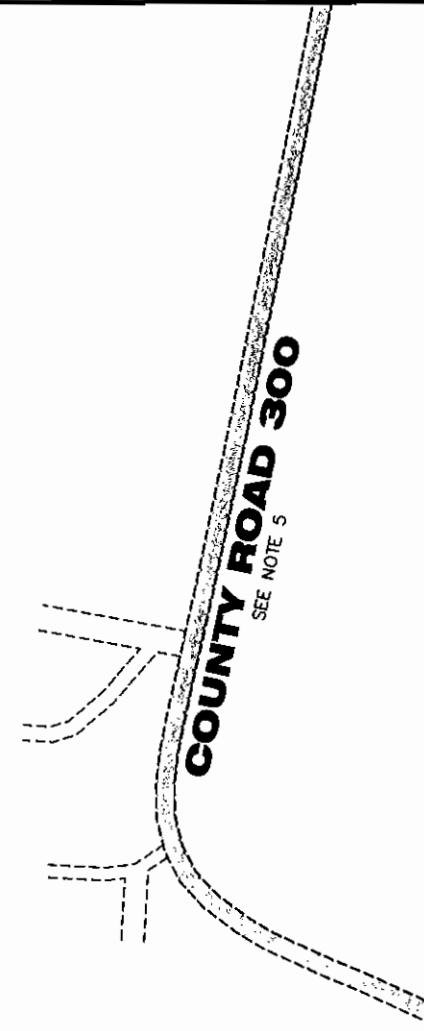
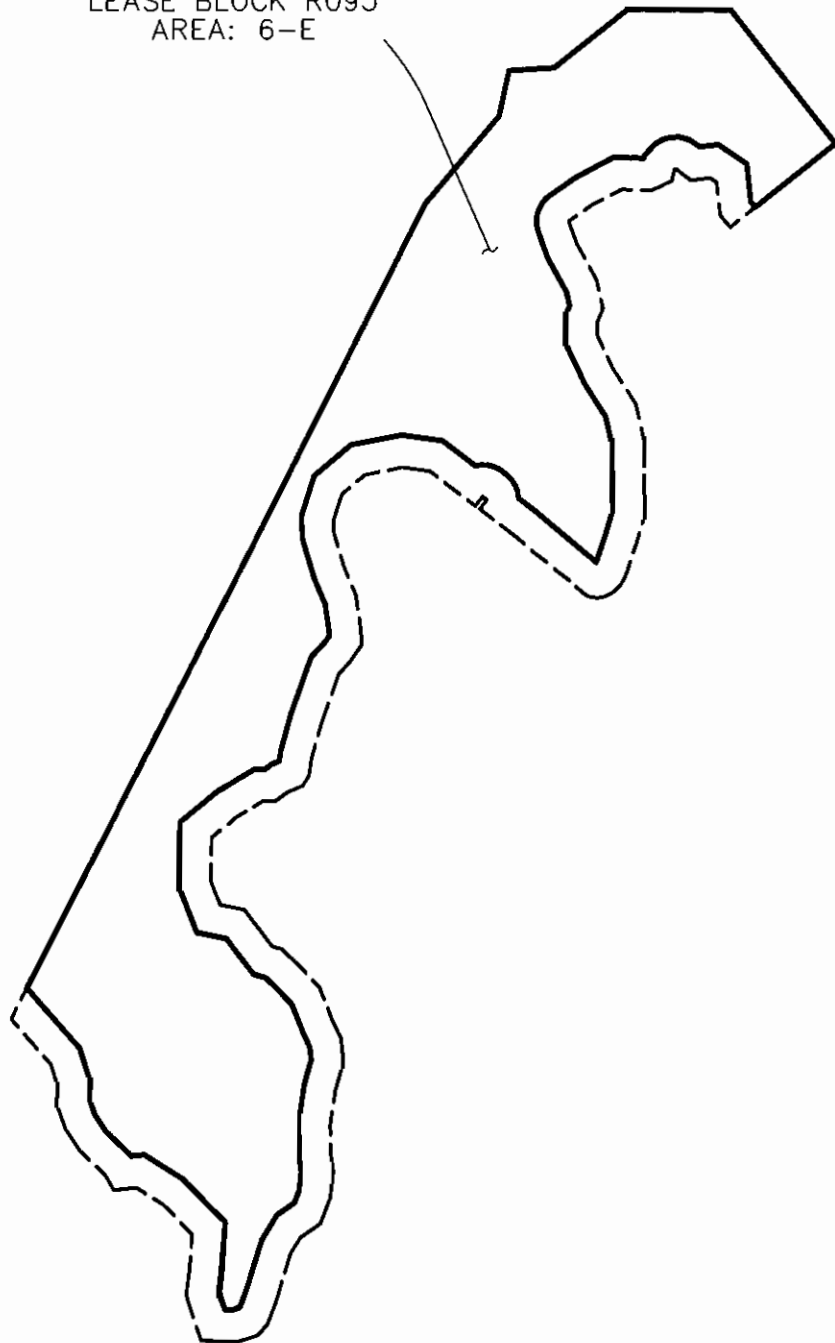

STANDARD LAND SURVEY
OF
3.9506 ACRES
SITUATED IN TRACT 153-3-22
AREA 6-E, LOTS W-1-A, W-1-B, W-1-C
AND 2 - 4
POSSUM KINGDOM LAKE
J. H. KARR SURVEY, ABSTRACT 1020
STEPHENS COUNTY, TEXAS

AECOM

AECOM USA GROUP, INC.
1200 SUMMIT AVENUE, SUITE 600
FORT WORTH, TEXAS 76102
WWW.AECOM.COM
817.698.6770